

K-LOK SINGLE POLE CONNECTOR
150A, 600V AC/DC
RECEPTACLE MALE



Item Number: KL-150SMGY
Color: Gray
Description: 150A K-LOK panel male, stud type



Listings
UL and cUL Listed file number E332947
Environment Rating: UL enclosure types 3R
Flame Class: HB / UL94

Material Information
Base Compound: Santoprene TPV
Temperature Rating: up to 105°C
Contact Material: Brass

Electrical Information
Amperage Rating: 150A Maximum
Voltage Rating: 600V AC/DC Maximum

Mechanical Information
Terminal Accommodation: #8 to #2 AWG
Connection type:
5/16"-18 threaded stud, length 0.75" (19mm)
Mounting Hole: 3 x Ø13/64"

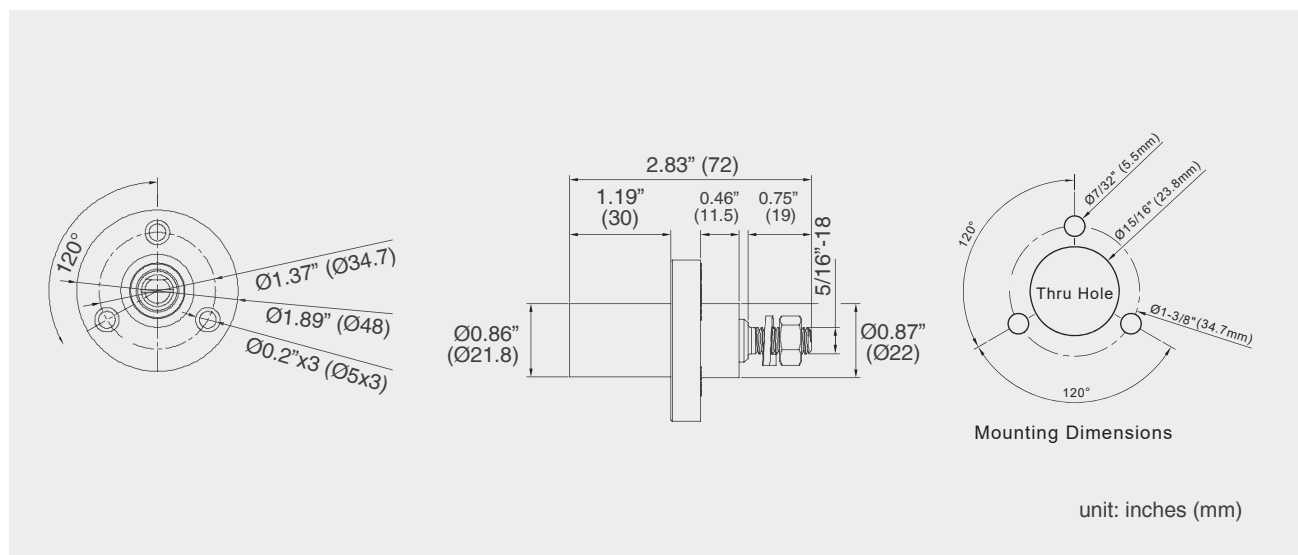

- Specifications subject to change without notice.
- www.stage.com.tw