

# K-LOK SINGLE POLE CONNECTOR

150A, 600V AC/DC

## RECEPTACLE MALE



**Item Number:** KL-150SMBK

**Color:** Black

**Description:** 150A K-LOK panel male, stud type



### Listings

UL and cUL Listed file number E332947

Environment Rating: UL enclosure types 3R

Flame Class: HB / UL94

### Material Information

Base Compound: Santoprene TPV

Temperature Rating: up to 105°C

Contact Material: Brass

### Electrical Information

Amperage Rating: 150A Maximum

Voltage Rating: 600V AC/DC Maximum

### Mechanical Information

Terminal Accommodation: #8 to #2 AWG

Connection type:

5/16"-18 threaded stud, length 0.75" (19mm)

Mounting Hole: 3 x Ø13/64"

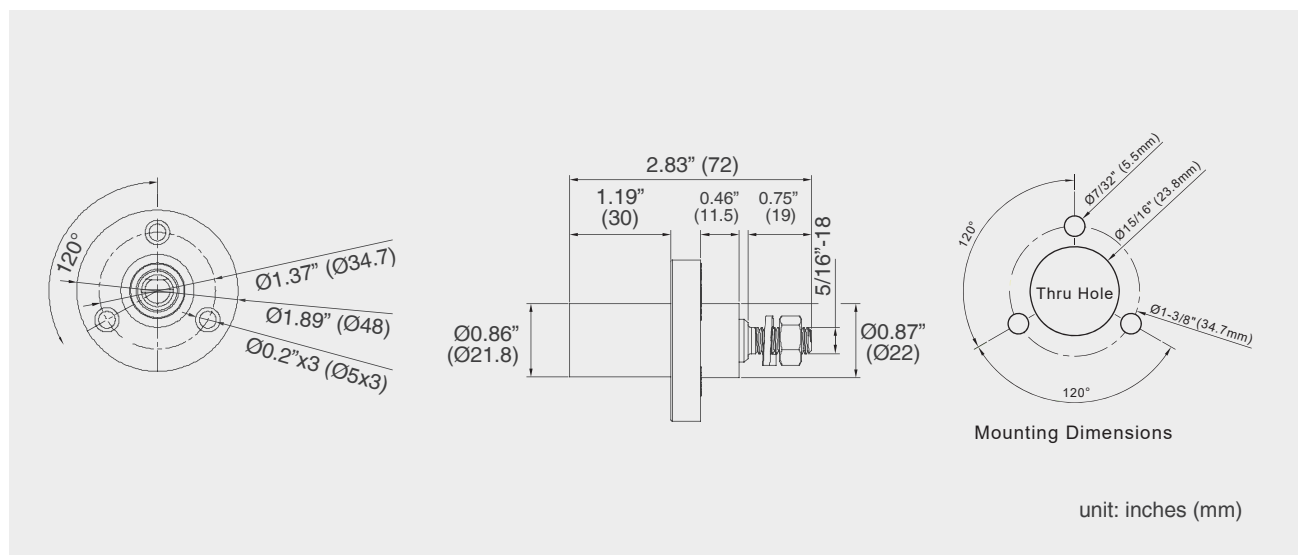

- Specifications subject to change without notice.
- [www.stage.com.tw](http://www.stage.com.tw)